

PROGETTI ESECUTIVI DEGLI IMPIANTI

- 1 Cilindro
- 2 70x100 a parete
- 3 70x100 totem
- 4 100x140 a parete
- 5 100x140 stelo
- 6 100x140 totem
- 7 140x200 a parete
- 8 140x200 standardo
- 9 140x200 a pettine
- 10 200x140 a parete
- 11 200x140 standardo
- 12 600x300

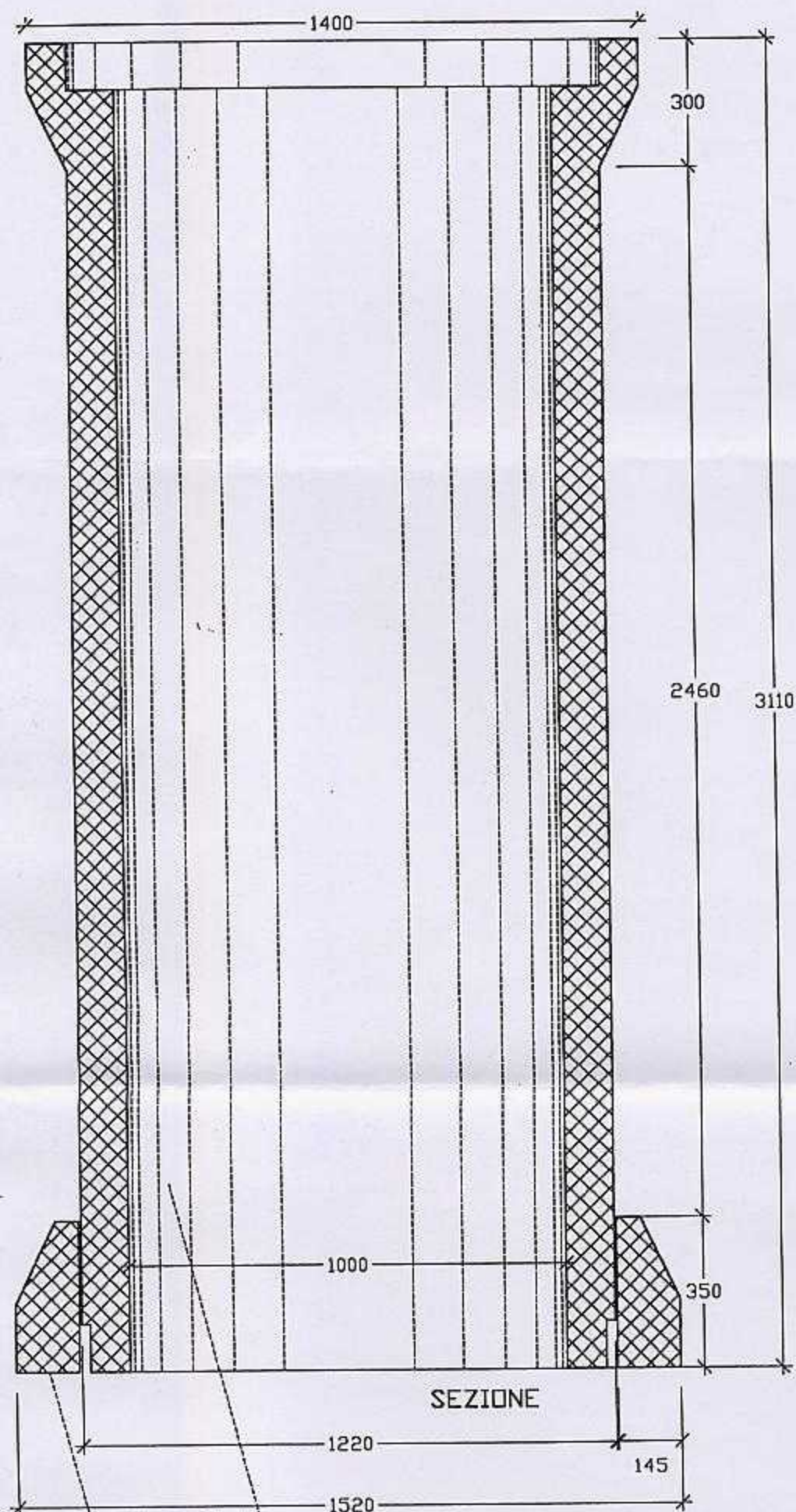

SEZIONE

TUBO CIRCOLARE IN CALCESTRUZZO
CON INNESTO A BICCHIERE L. 300 CM.
DIAMETRO INTERNO 100 CM.

ANELLO DI BASE IN CALCESTRUZZO
REALIZZATO APPPOSITAMENTE E FISSATO
AL TUBO CON COLLANTI EPOSSIDICI

IL PESO COMPLESSIVO DEL MANUFATTO E' DI
CIRCA 3200 KG.
IN RELAZIONE AL PIANO SUL QUALE ANDRA'
INSTALLATO OCCORRERA' VERIFICARE SE
OCCORRE UNA BASE DI RIPARTIZIONE DEL
CARICO (FONDAZIONE IN C.L.S. O PIASTRA IN
FERRO) DIMENSIONATA SECONDO LA
PORTATA DEL PIANO STESSO E POSTA IN
OPERA A FILO DEL LIVELLO PEDONABILE PER
NON COSTITUIRE OSTACOLO.

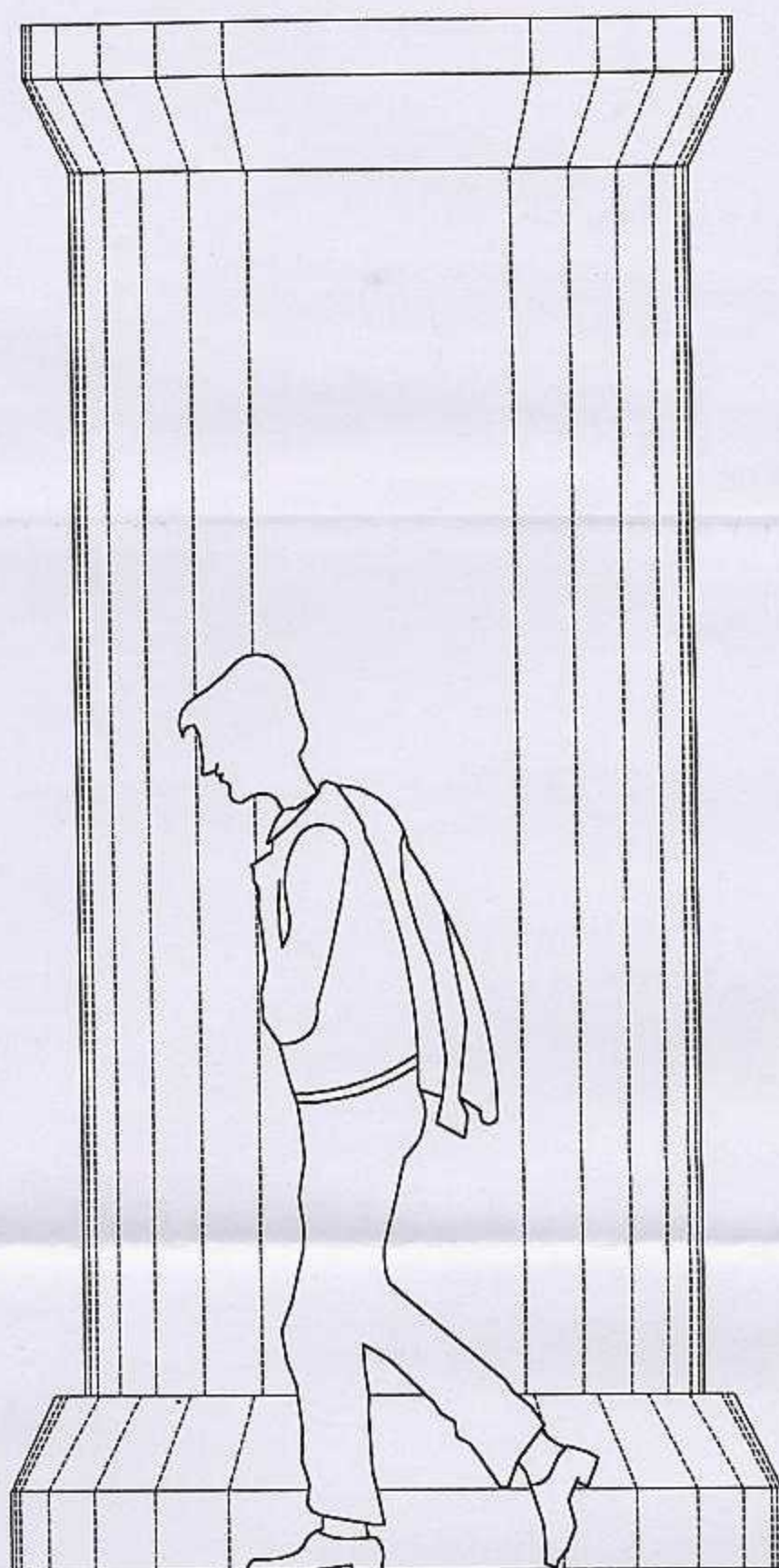

VISTA FRONTALE

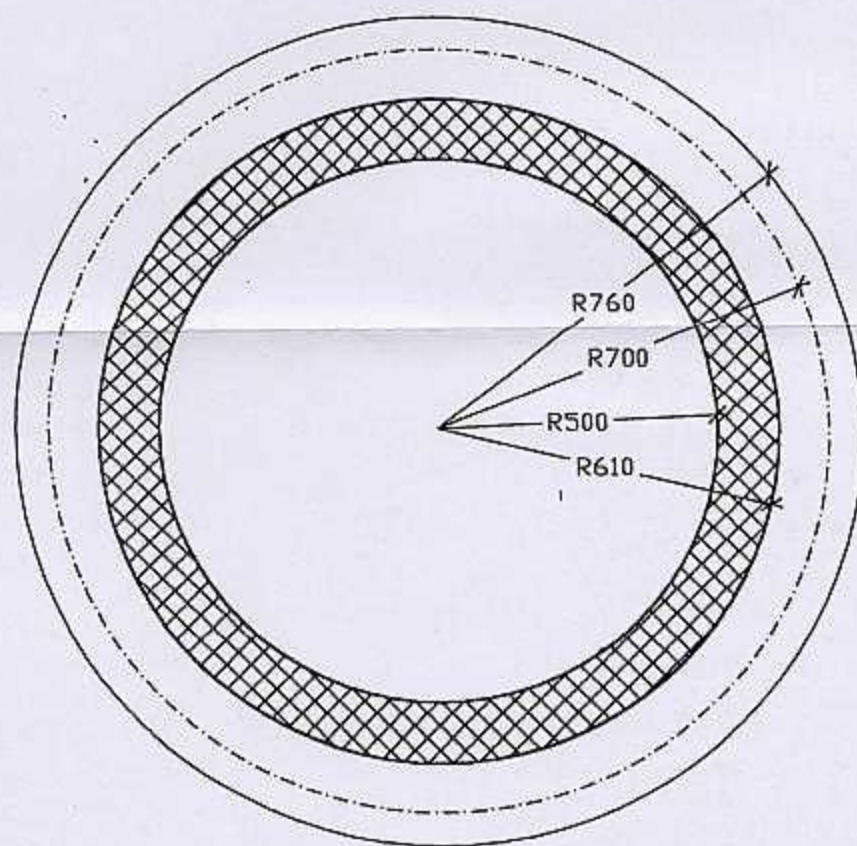

PIANTA SEZIONATA

1-CILINDRO

STRUTTURA IN CALCESTRUZZO VIBRATO

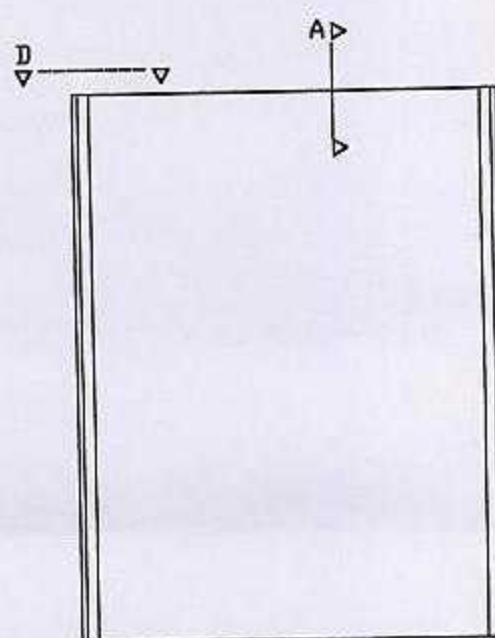

VISTA FRONTALE DELLA STRUTTURA
COMPLETA DI PANNELLO

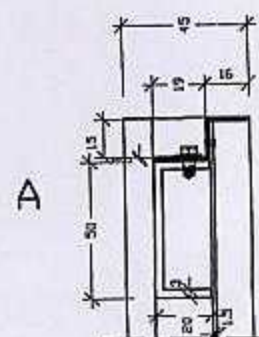

A

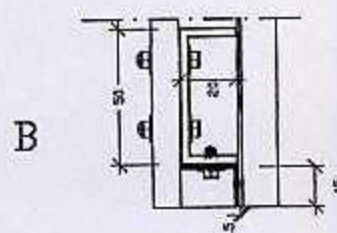

B

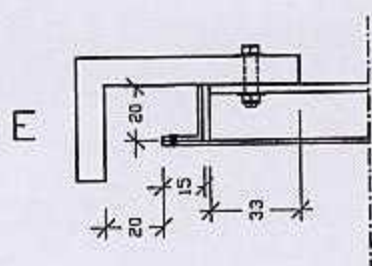
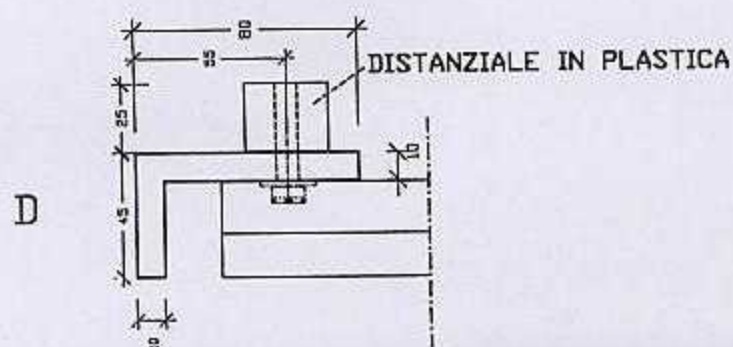

2 - 70 x 100 A PARETE

STRUTTURA IN ACCIAIO

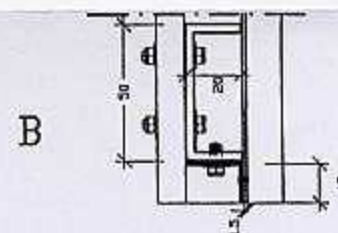
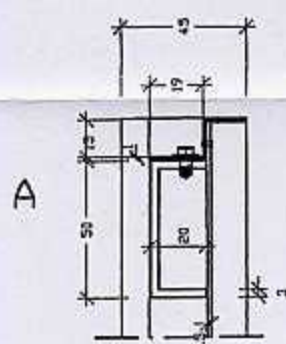
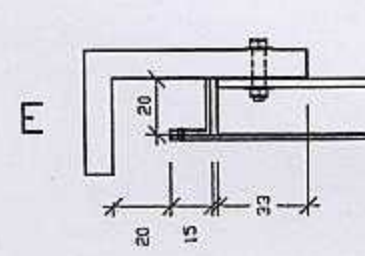
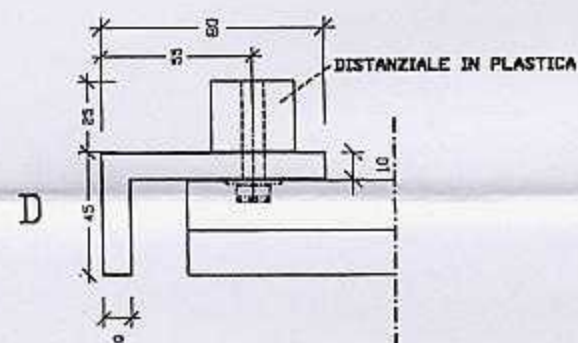
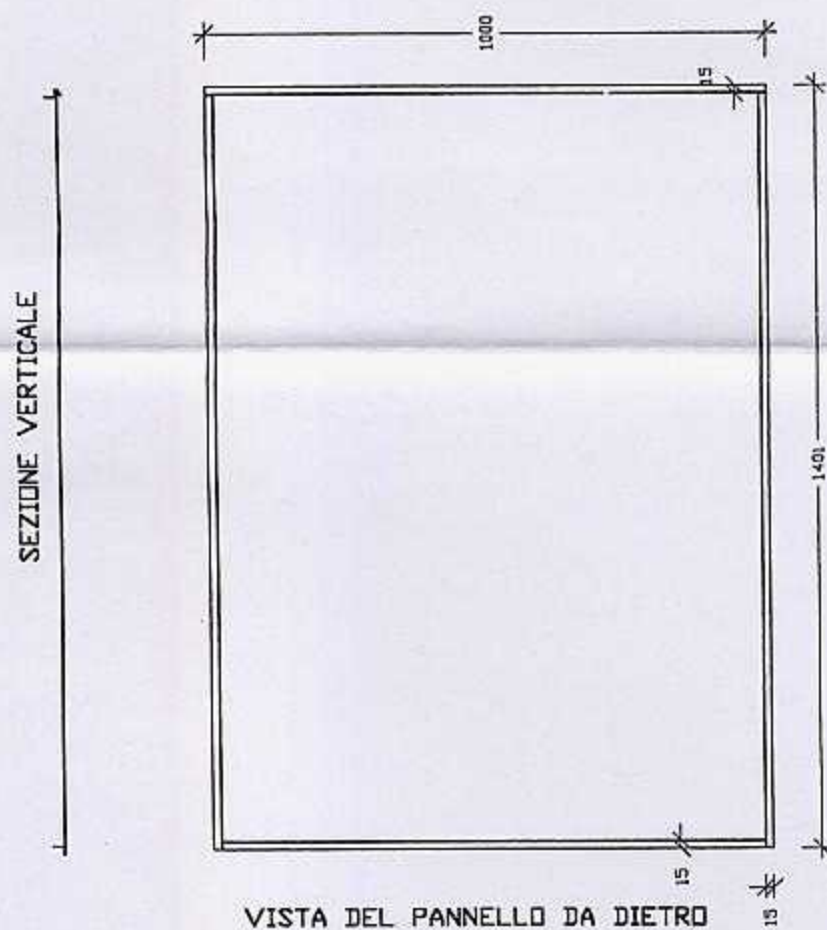
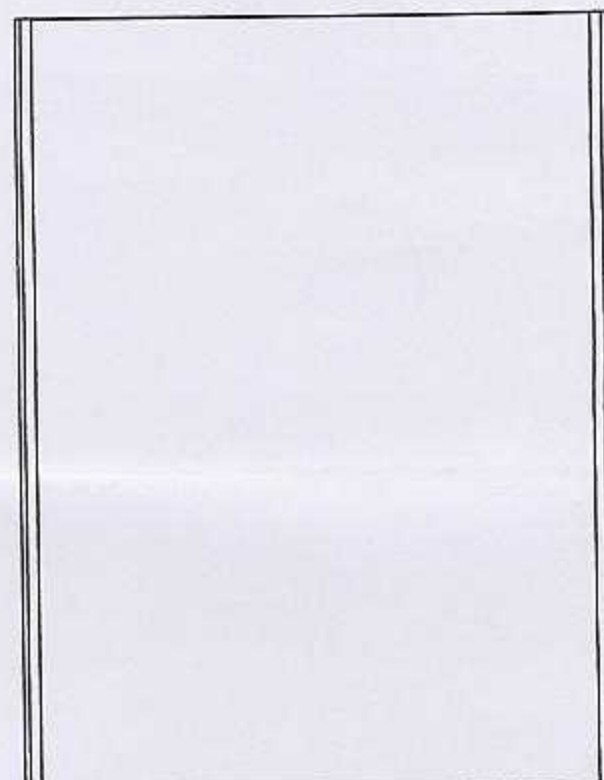
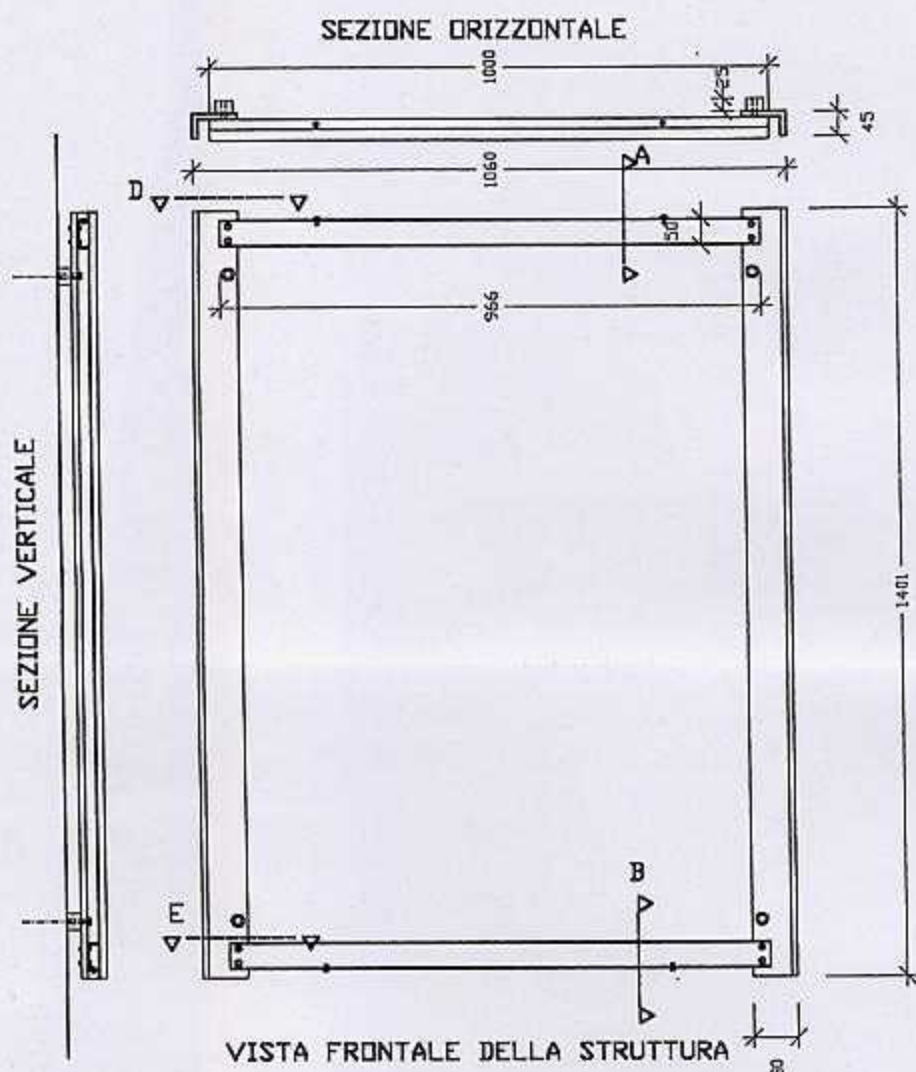

I PROFILATI IN ACCIAIO SONO VERNICIATI A FORNO CON VERNICE EPOSSIDICA COLORE R.A.L. 7012
IN RELAZIONE AL MATERIALE UTILIZZATO PER I PANNELLI (LAMIERA ZINCATA, ALLUMINIO, MATERIALI PLASTICI)
LE NERVATURE POSSONO ESSERE REALIZZATE PER PIEGATURA, RIVETTATURA, SALDATURA O INCOLLAGGIO

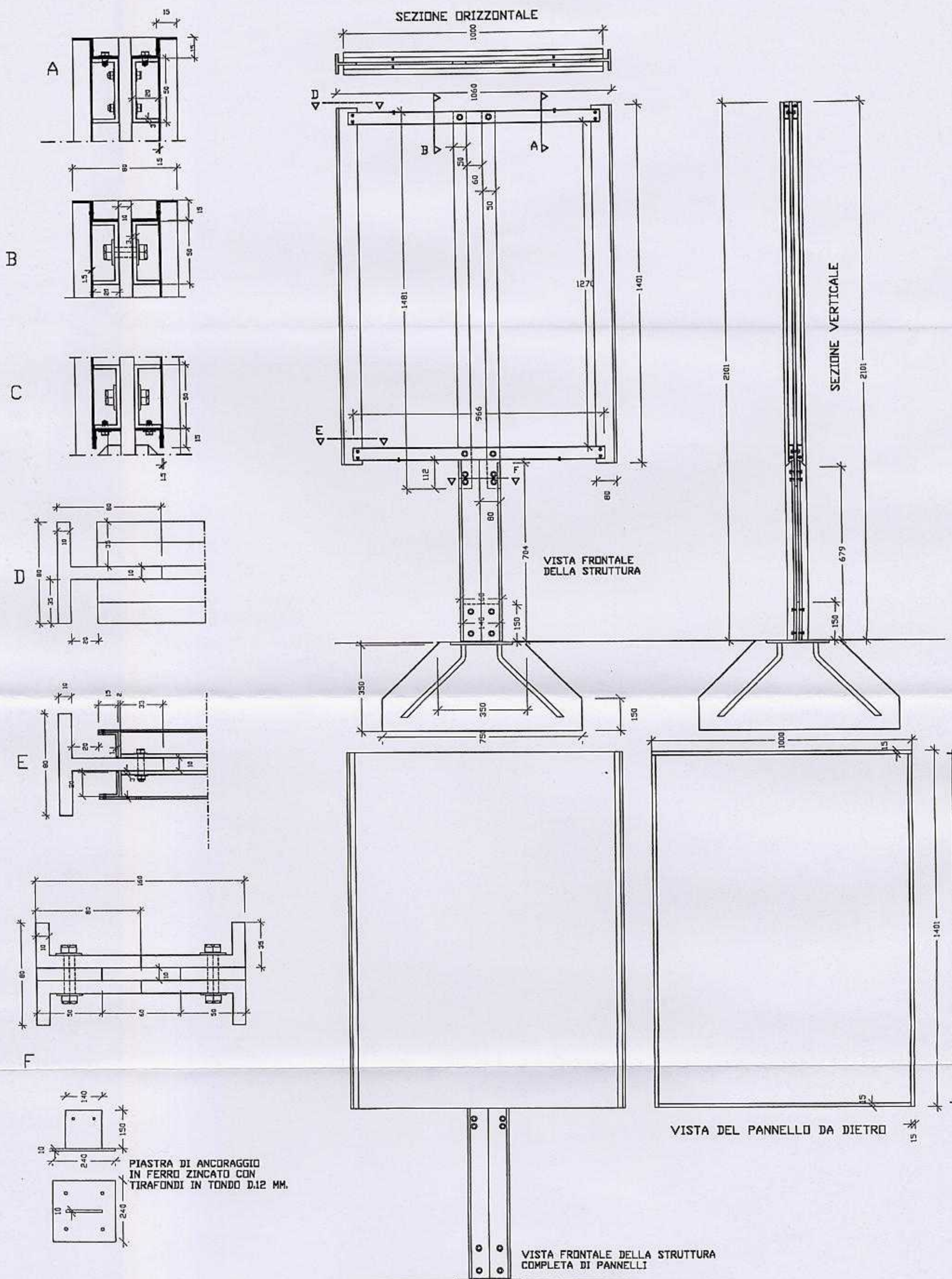

I PROFILATI IN ACCIAIO SONO VERNICIATI A FORNO CON VERNICE EPOSSIDICA COLORE R.A.L. 7012
 IN RELAZIONE AL MATERIALE UTILIZZATO PER I PANNELLI (LAMIERA ZINCATA, ALLUMINIO, MATERIALI PLASTICI)
 LE NERVATURE POSSONO ESSERE REALIZZATE PER PIEGATURA, RIVETTATURA, SALDATURA O INCOLLAGGIO

5 - 100x140 STELO

STRUTTURA IN ACCIAIO

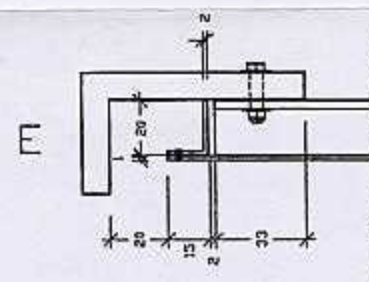
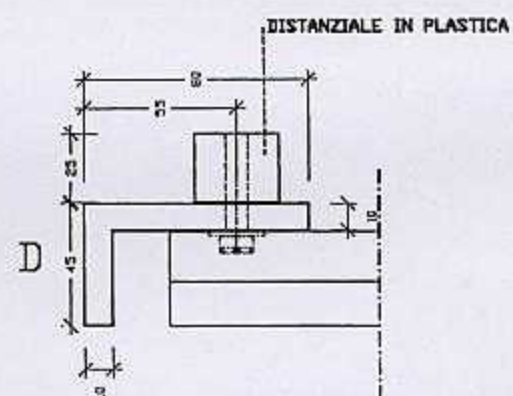
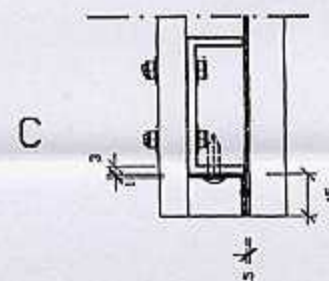
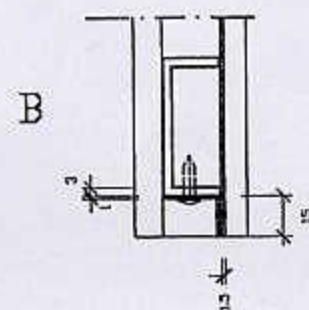
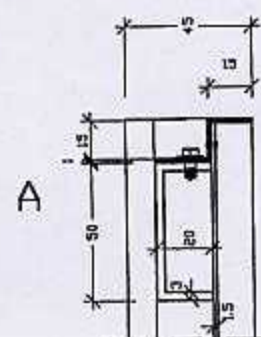
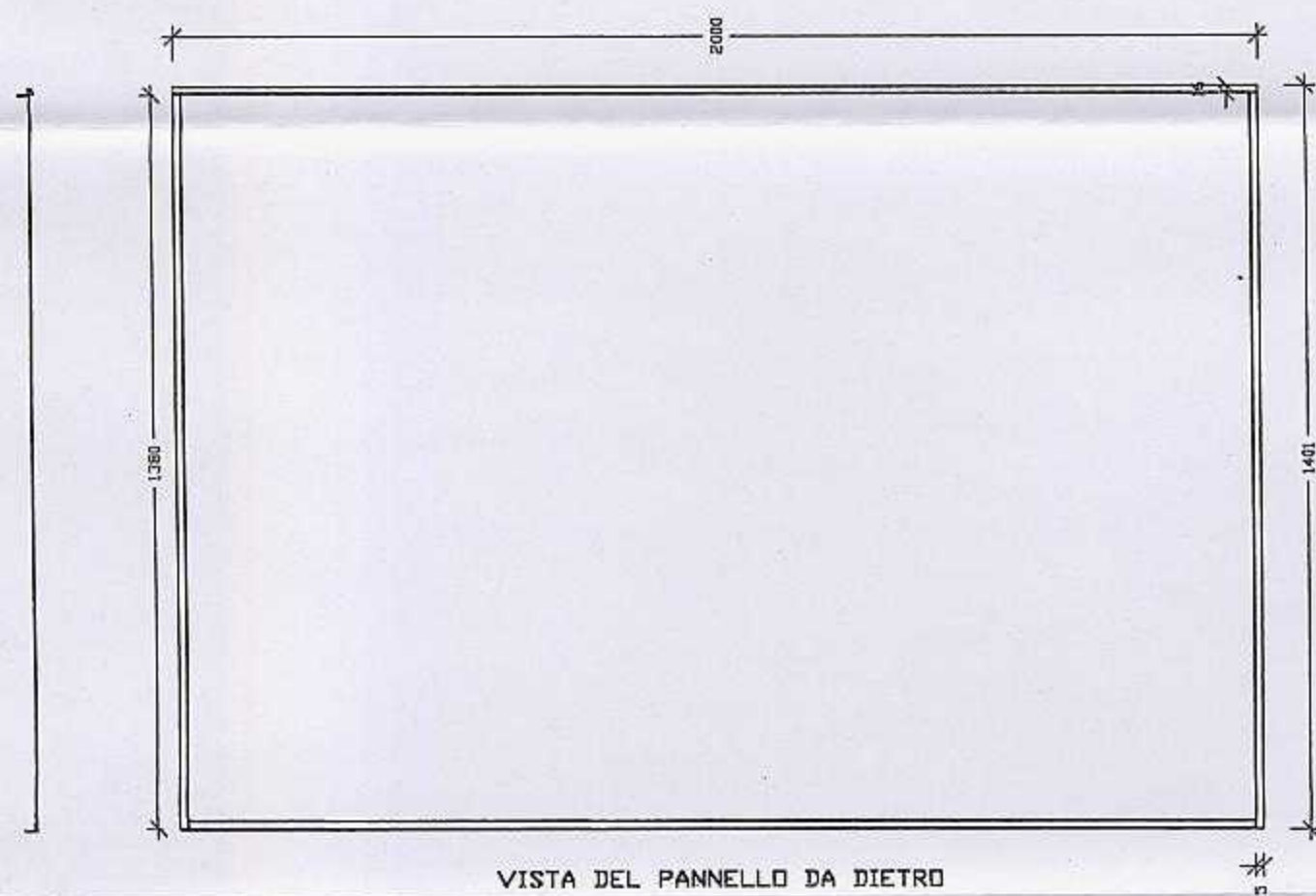
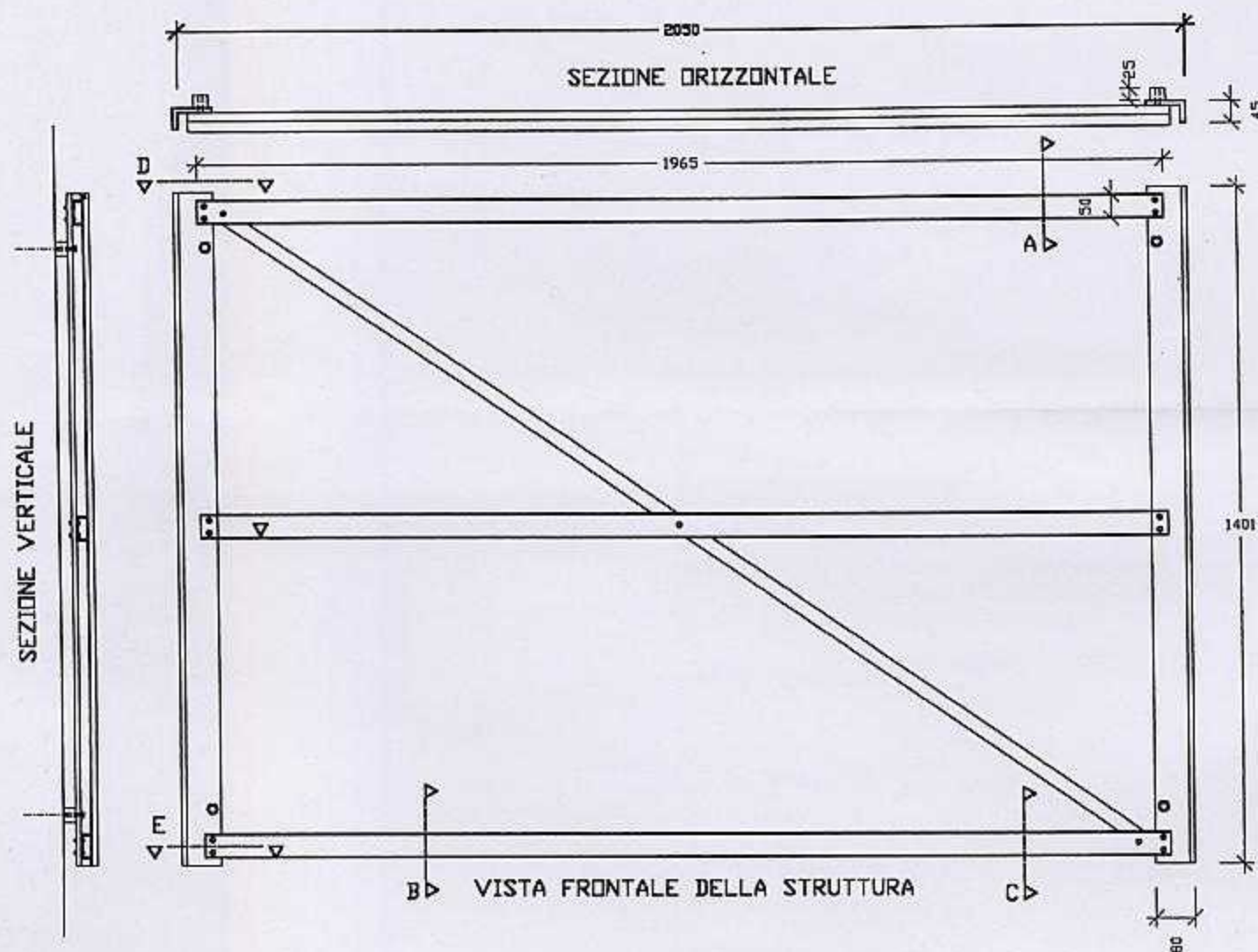

I PROFILATI IN ACCIAIO SONO VERNICIATI A FORNO CON VERNICE EPOSSIDICA COLORE R.A.L. 7012
 IN RELAZIONE AL MATERIALE UTILIZZATO PER I PANNELLI (LAMIERA ZINCATA, ALLUMINIO, MATERIALI PLASTICI)
 LE NERVATURE POSSONO ESSERE REALIZZATE PER PIEGATURA, RIVETTATURA, SALDATURA O INCOLLAGGIO

9 - 200x140 A PARETE

STRUTTURA IN ACCIAIO

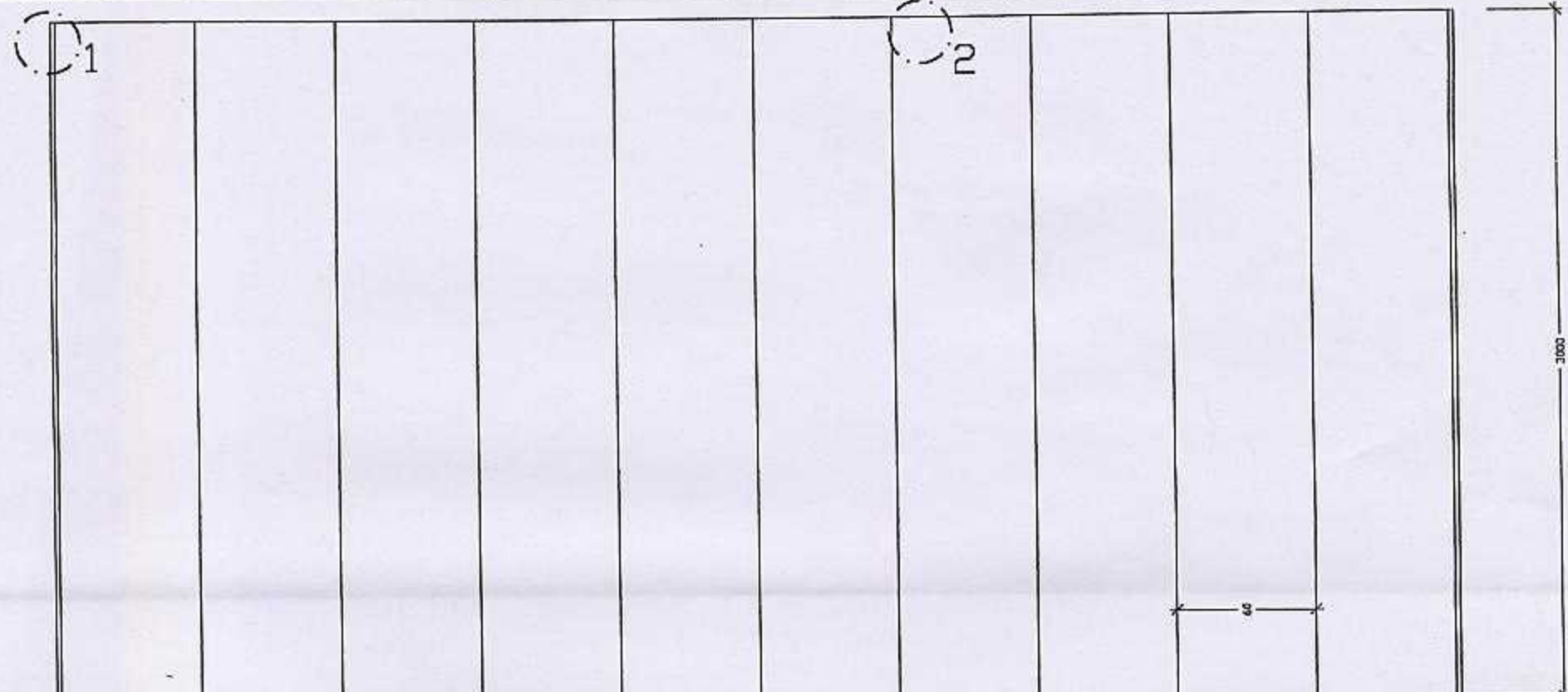

VISTA FRONTALE



SEZIONE VERTICALE

2

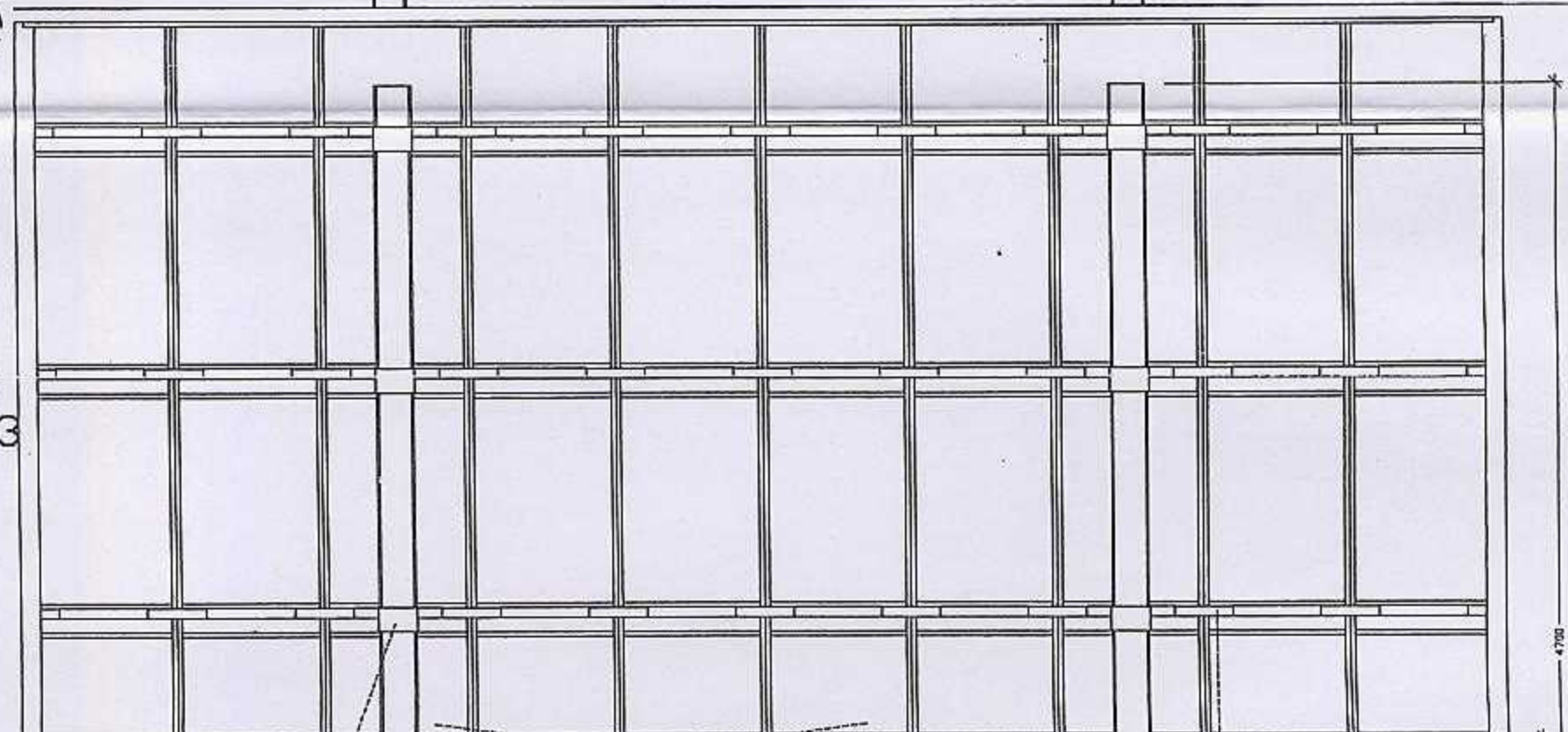

STAFFA SCORREVOLE

PANNELLI MODULARI IN LAMIERINO ZINCATO
(INTERASSE E NUMERO A DISCREZIONE)

PROFILATO A "C"

TRAVE HEA 140
SERIE ALLEGGERITA

VISTA DA DIETRO

IL DIMENSIONAMENTO DEL PLINTO
DI FONDAZIONE VARIA SECONDO
L'UBICAZIONE E IL TERRENO

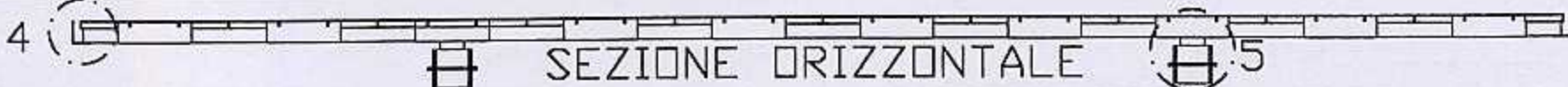

SEZIONE ORIZZONTALE

I PROFILATI IN ACCIAIO SONO VERNICIATI A FORNO CON VERNICE EPOSSIDICA, COLORE R.A.L. 7012

11 - 600x300 MONOFACCIALE

STRUTTURA IN ACCIAIO

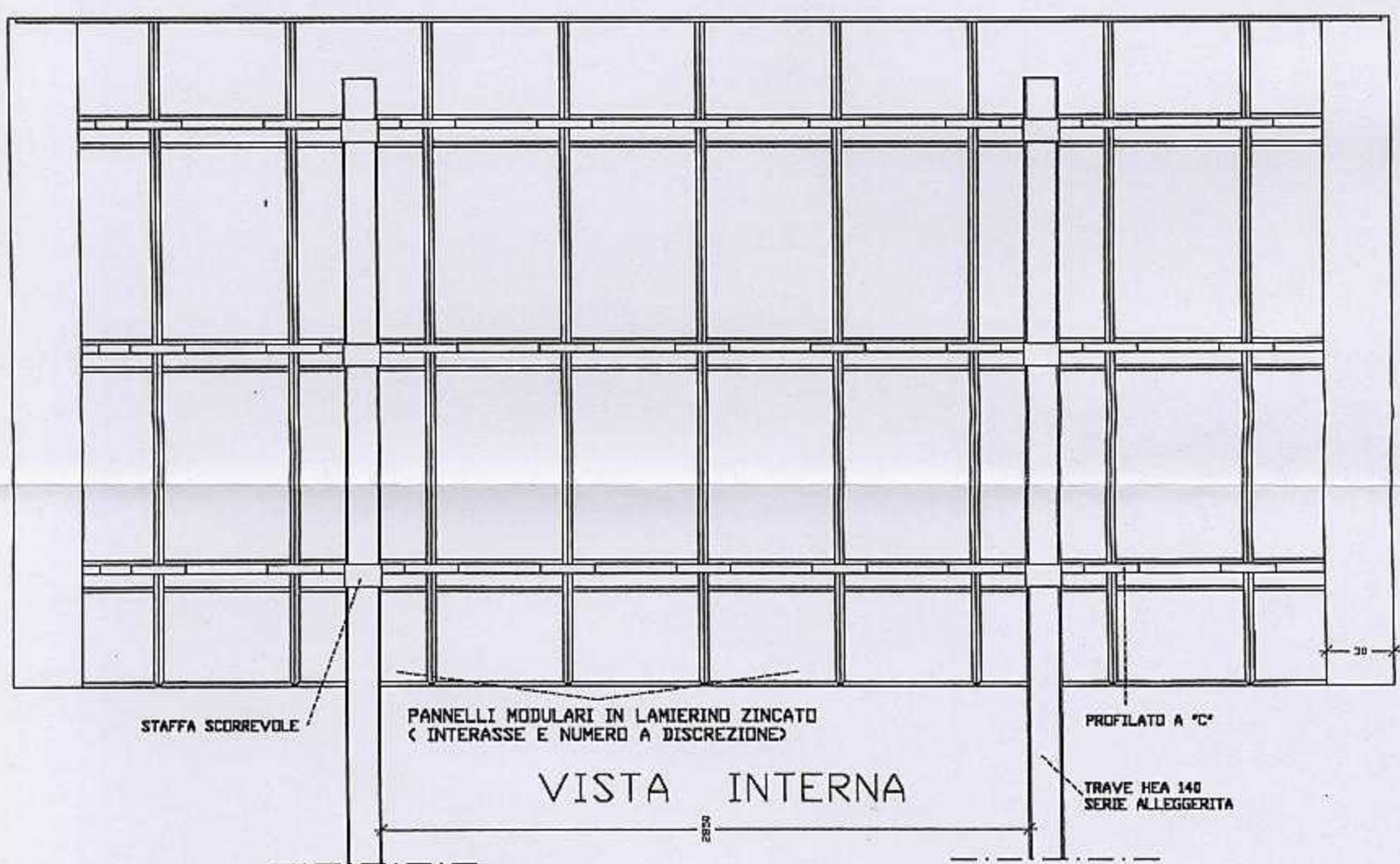
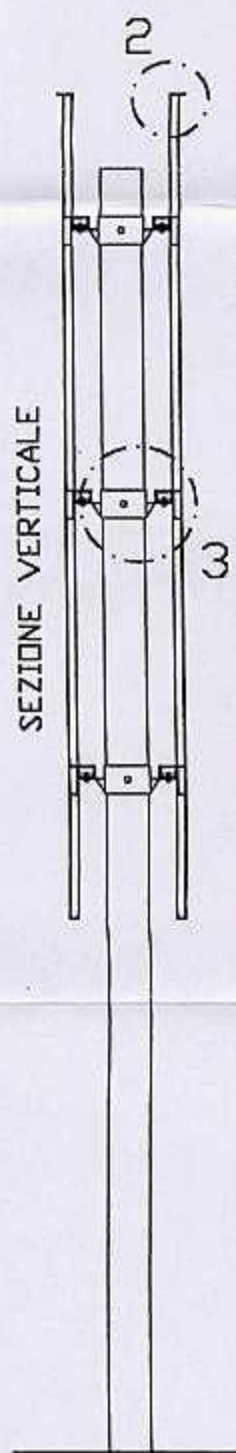
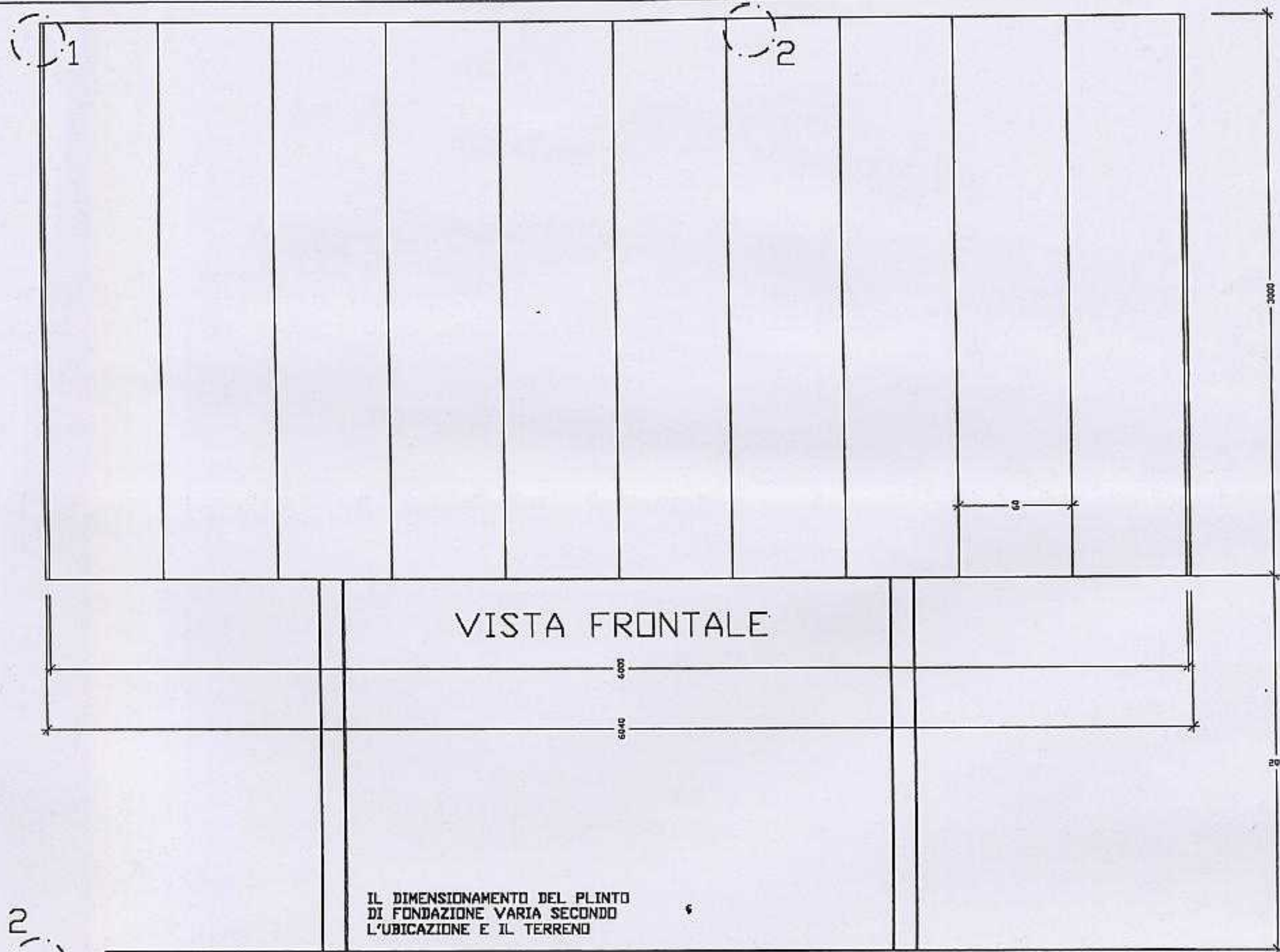

I PROFILATI IN ACCIAIO SONO VERNICIATI A FORNO CON VERNICE EPOSSIDICA COLORE R.A.I. 7012

11 - 600x300 BIFACCIALE



COPRIFILO LATERALE
ZINCATO E VERNICIATO



COPRIFILO SUPERIORE
ZINCATO



TRAVERSO IN PROFILATO A 'C'

TRAVE HEA 140
SERIE ALLEGGERITA

STAFFA SCORREVOLE

PANNELLO MODULARE



VISTA DA DIETRO DEL PANNELLO



COPRIFILO LATERALE ZINCATO E VERNICIATO
FISSATO DIRETTAMENTE AI PANNELLI FINALI
SPESSORE MM. 3



STAFFA SCORREVOLE

TRAVE HEA 140
SERIE ALLEGGERITA

11 - 600x300 BIFACCIALE

A

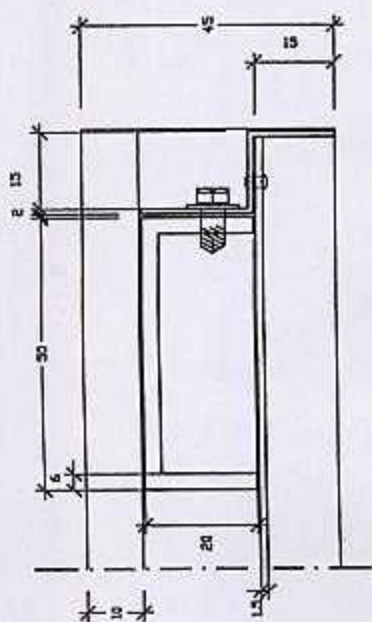

D

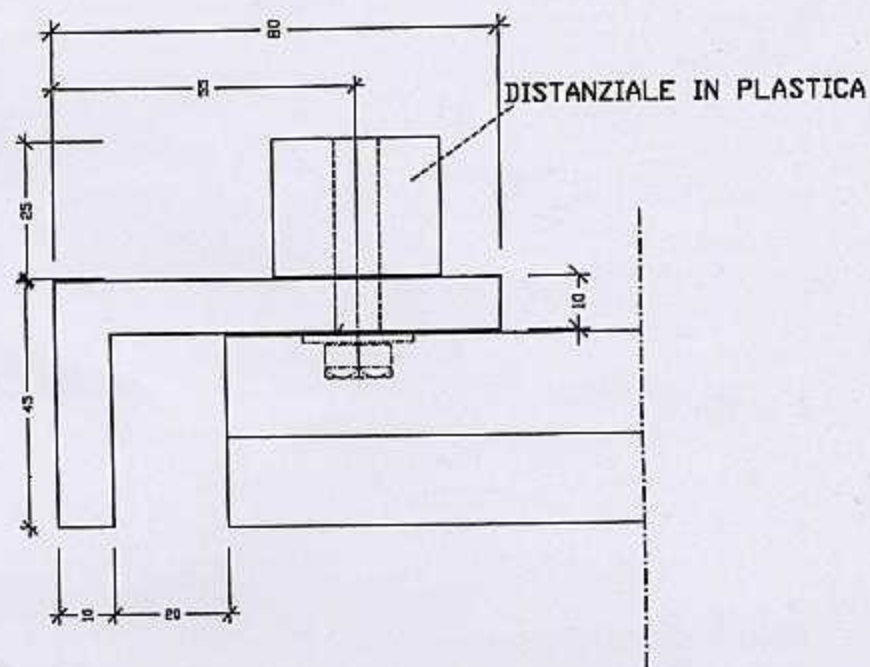

E

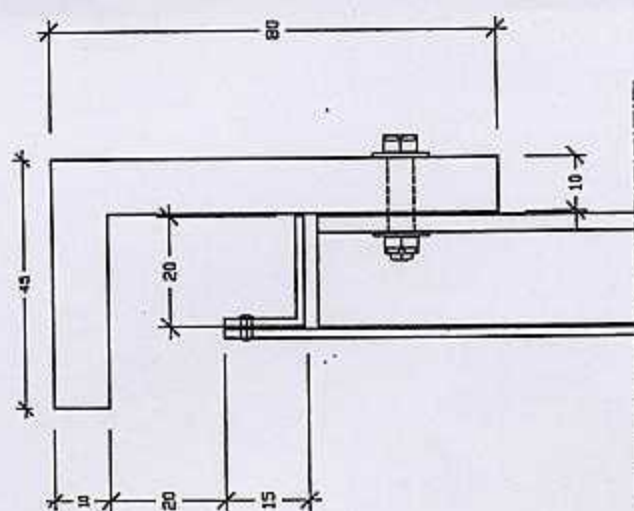

B

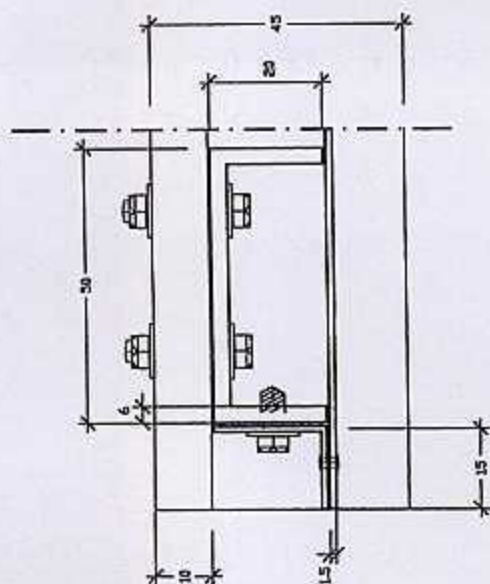

PARTICOLARI DEGLI IMPIANTI MONOFACCIALI (TIPI 2, 4, 6, 7, 9)

A

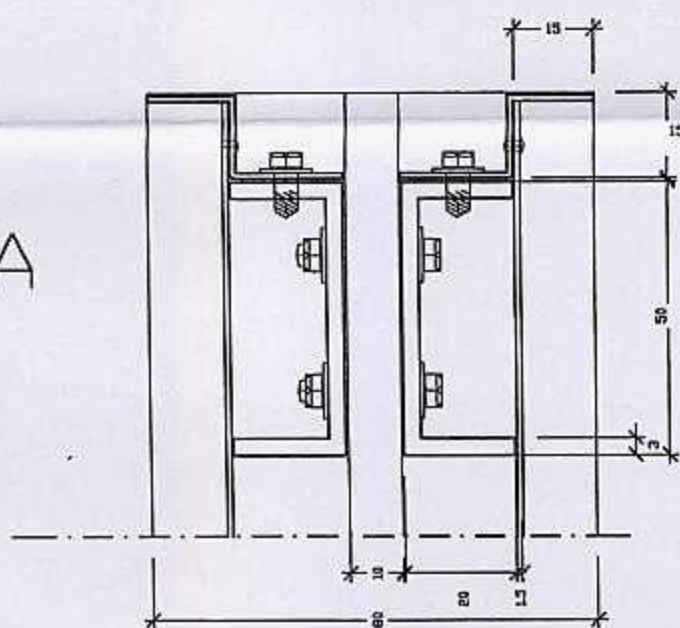

D

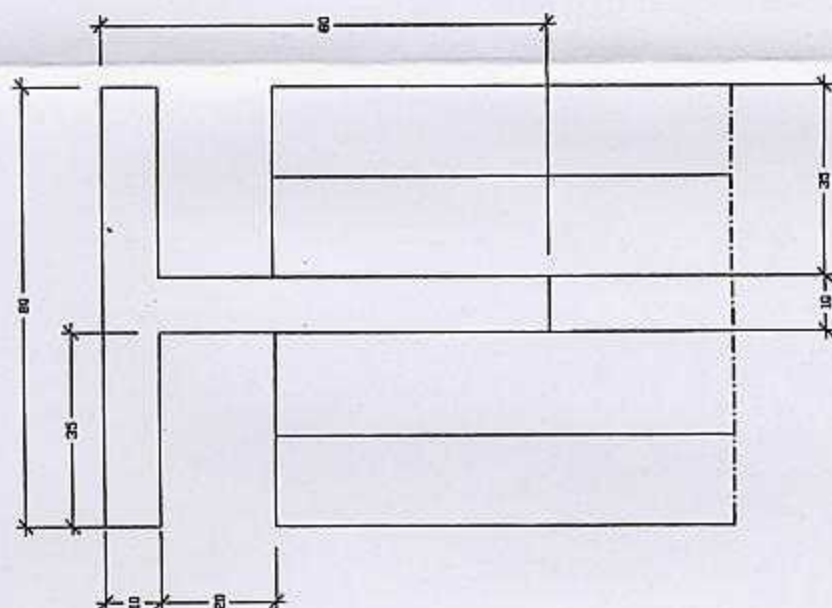

C

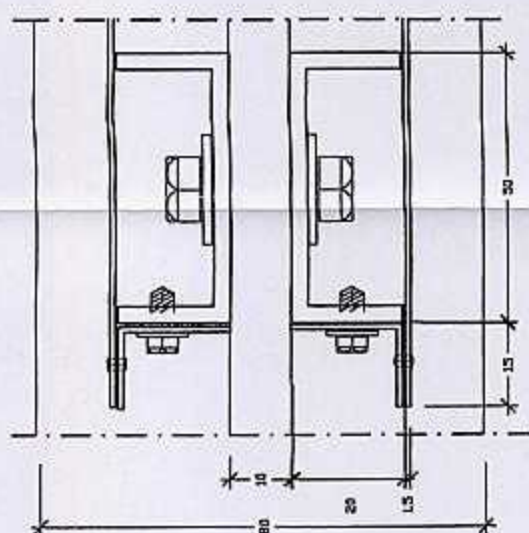

E

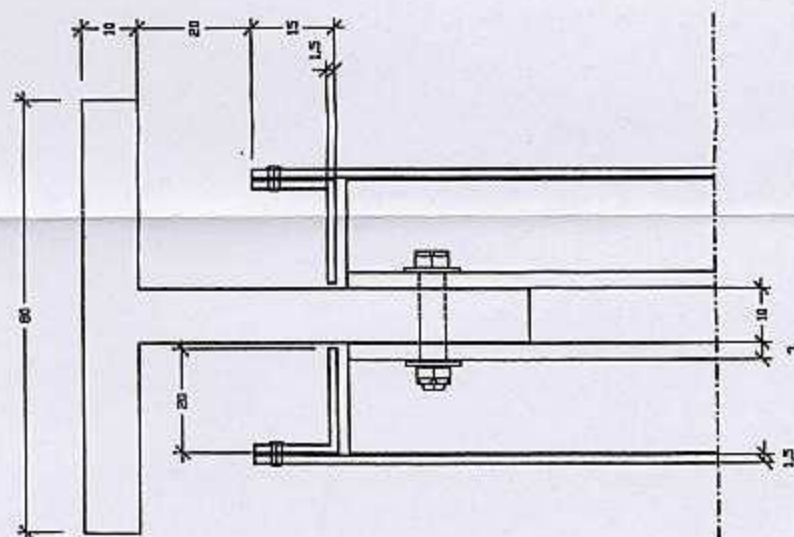

PARTICOLARI DEGLI IMPIANTI BIFACCIALI (TIPI 3, 5, 8, 10)

IN RELAZIONE AL MATERIALE UTILIZZATO PER I PANNELLI (LAMIERA ZINCATO, ALLUMINIO, MATERIALI PLASTICI)
LE NERVATURE POSSONO ESSERE REALIZZATE PER PIEGATURA, RIVETTATURA, SALDATURA O INCOLLAGGIO

PARTICOLARI COSTRUTTIVI RICORRENTI